

Name: synthetic resin

Model:1050mm

Material: synthetic resin

Origin: Foshan, Guangdong

Thickness: 2.5-3.0mm

Applicable scenarios: villa roofs, tourist attractions, rural transformation

Synthetic resin roofing tile color card selection

customized any color



Brick red



Purplished red



Dark green



Gray



Blue

Dimensional measurement method

both sides

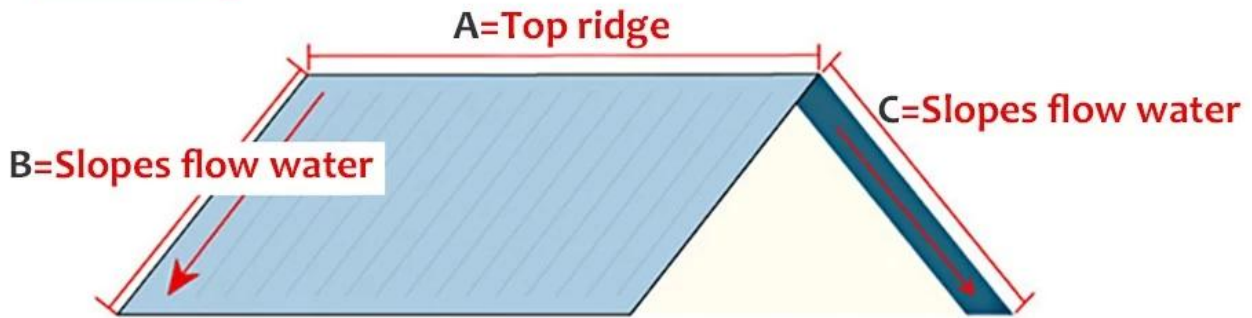

1. Measure the dimension of the **A** top ridge.
2. Measure the dimensions of **B**
3. Measure the dimensions of **C**

Measure all the dimensions (don't forget the eaves)

four sides

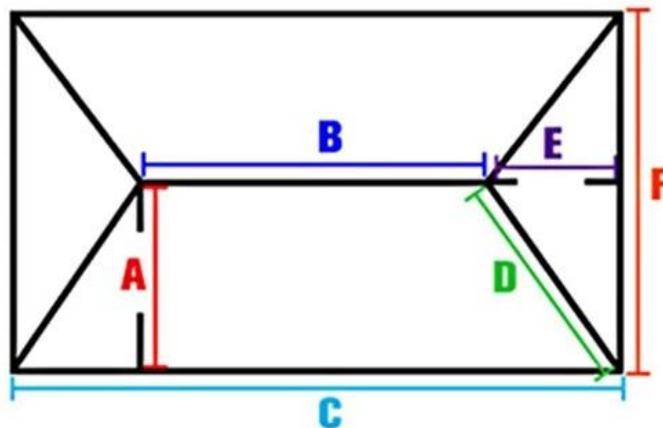

1. Measure the dimension of the **B** top ridge.
2. Measure the dimensions of ramp **A**
3. Measure the width of **C**
4. Measure the dimensions of the **D** diagonal ridge.
5. Measure the dimensions of ramp **E**
6. Measure the width of **F**

Measure all the dimensions (don't forget the eaves)

Roofing accessories

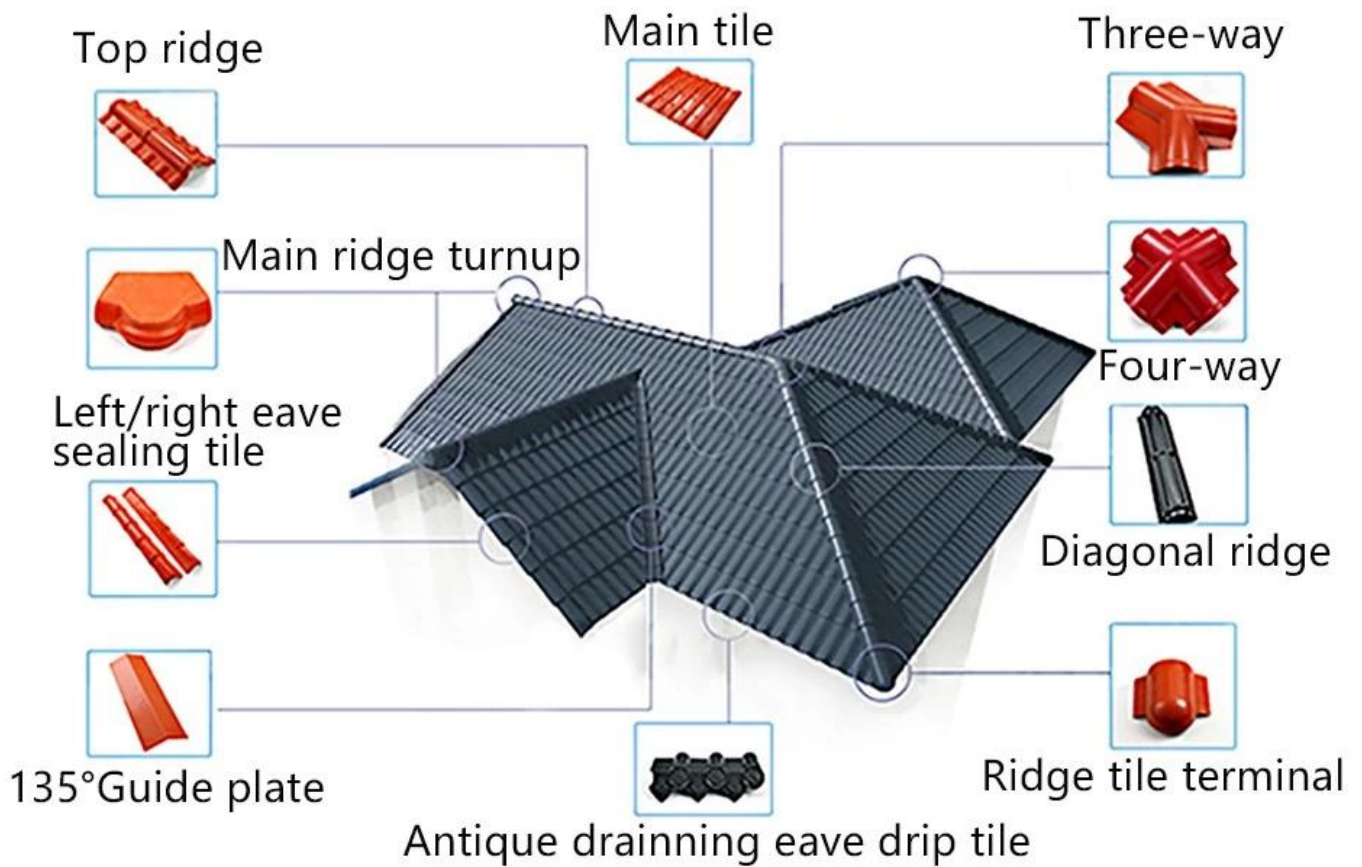

Installation considerations

1. The purlins can use square pipe (60x40x3mm)
2. The purlins can use C-shaped steel (100x50x20x3mm)
3. The purlins can use anti-corrosion wood square (60x40mm)
4. purlin spacing of 660mm

Our Factory

Zhongxingcheng New Material Co., Ltd. 佛山市南海区 Foshan City, Nanhai District China
 专业生产ASA, APVC, PVC, FRP, PVC, PC



Factory display



9 production lines



Raw material warehouse



Product comparison

Learn all about our products

Dacheng resin roofing tile

Recyclable resin roofing tiles



Brand new raw materials imported
bright color, long service life
30~50 years



Recycled materials, dull color, easy
to have black spots in appearance
very short life.



Brand new material, good
plasticization, long service life



Recyclable material, reduced
toughness, many impurities,
easy to break



ASA surface thickness 0.1~0.15mm
does not foam and does not fall off



The thickness of the surface layer of
the film is 0.05~0.1mm, which is
easy to blister and fall off

Exhibition



Certificate

Security sense of authoritative testing

Multiple quality inspection and testing to ensure good quality.



IOS9000 certified



China Metrology Certification



CAL certification



* 請提供詳細的技術規格書及產品樣品？

* 請提供 OEM 及 ODM 的詳細資訊及相關證明文件？

* 請提供詳細的報價單？

* 請提供詳細的生產及出貨計劃？

* 請提供詳細的品質管理系統及認證？

* 請提供詳細的客戶服務及售後支援計劃？

* 請提供詳細的財務狀況及信譽證明？

* 請提供詳細的付款條件：T/T 30% 預付，其餘 70% 於出貨前付清。

• 請提供詳細的交貨日期：7 天內交貨，其餘 30% 於出貨前付清。

• FOB Shipping Port: 請提供詳細的港口資訊及相關證明文件。