

## Product show

ZXC [ASA Synthetic resin roof tile](#) super toughness, 30-year warranty. It uses better resin as raw material to ensure better toughness and longer service life. The surface is as bright as a mirror. Containing no asbestos and radioactive elements, recyclable and fully meeting green environmental protection requirements. High-grade plants, steel factories, warehouses, farm market, market access, sheds and other high-end roofing materials.

# Resin tile dormer modeling design



Product Name	Synthetic Resin Roof Tile
Brand	ZXC
Place of Origin	Foshan city,Guangdong province,China(Mainland)
Material	Acrylonitrile Styrene acrylate copolymer,Polyvinyl chloride, Calcium powder,other chemical materials
Guarantee	25 years
Certification	ISO9001 / SGS / CE
Delivery Time	1x20GP for 6 days,1x40GP for 7 days
Section Length	219mm
Overall Width	1050mm
Effective Width	960mm
Thickness	2.3mm / 2.5mm / 2.8mm / 3.0mm
Length	Must be a multiple of section
Wave Spacing	160mm

Wave Height	30mm
-------------	------

Click [synthetic resin roof tile suppliers](#) to learn more

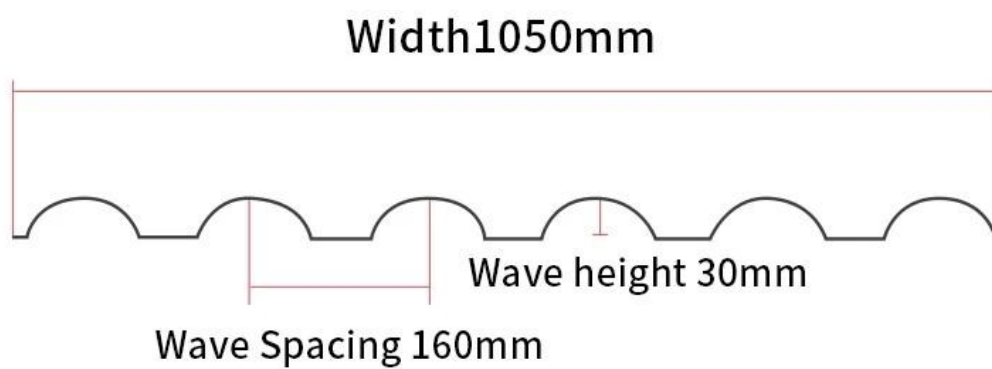

Brick red



Purplished red



Dark green

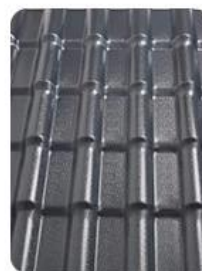

Gray



Blue

## **Application**

- 1: It has long-lasting color
- 2: light weight,
- 3: self-waterproof,
- 4: tough, thermal insulation,
- 5: sound insulation
- 6: corrosion resistance
- 7: wind and shock resistance
- 8: hail resistance, and stain resistance
- 9: .Green environmental protection
- 10: fire prevention, insulation
- 11: easy installation



# Dimensional measurement method

## both sides

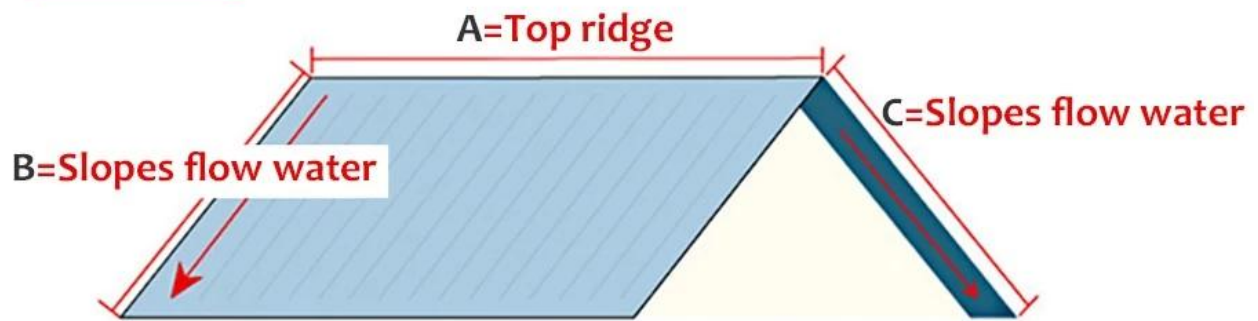

1. Measure the dimension of the **A** top ridge.
2. Measure the dimensions of **B**
3. Measure the dimensions of **C**

Measure all the dimensions (don't forget the eaves)

## four sides

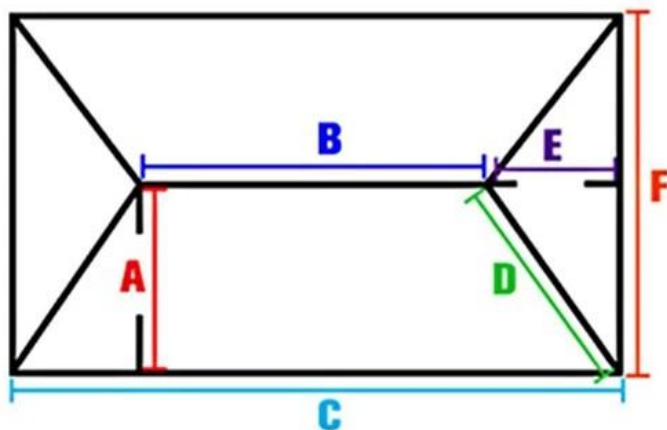

1. Measure the dimension of the **B** top ridge.
2. Measure the dimensions of ramp **A**
3. Measure the width of **C**
4. Measure the dimensions of the **D** diagonal ridge.
5. Measure the dimensions of ramp **E**
6. Measure the width of **F**

Measure all the dimensions (don't forget the eaves)



## Project show pictures

Guangxi bungalow renovation



Qingyuan Scenic Area



Foshan residential roof



Renovation of old houses in Guangzhou





## Product comparison

We're not afraid of contrast. Quality is the last word.

Zhongxingsheng



General manufacturers



Long-lasting color, durable



Inferior resin tiles are easy to fade



Only three layers of brand new material are produced.

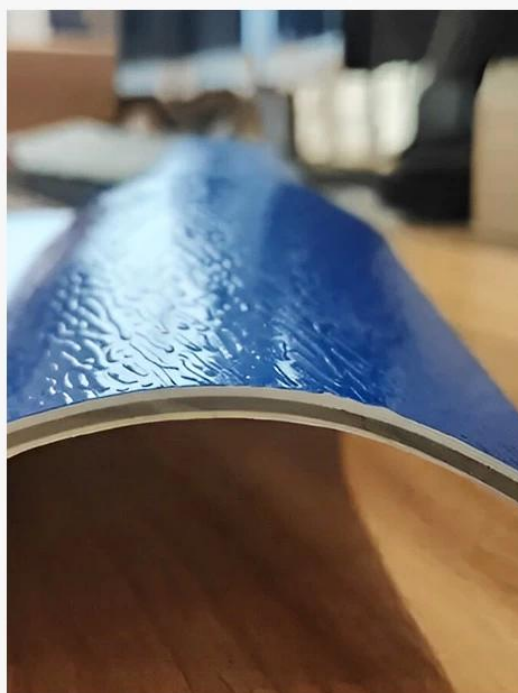

Four layers are compressed and mostly recycled material



# Our Factory

Zhongxingcheng New Material Co., Ltd. is located in Foshan City, Nanhai District China is a manufacturer specializing in the production of ASA synthetic resin tile, APVC anti-corrosion composite tile, PVC anti-corrosion tile, PVC sink, PVC plate, Transparent FRP Roof Sheet, PVC, PC transparent tile.





Factory display



9 production lines



Raw material warehouse



# Exhibition





# Certificate

# Official quality inspection, quality assurance

In line with the national roofing building materials standard.





## Packaging



## FAQ

**\*Are you manufacturer or trader?**

\*Yes, we are real Manufacturer, there are many pictures in our company introduction .if you need other special product, we will do our best to help you, so we can build a long-term business relationship.

**\*Can I order the product with i want to profile?**

\*Of course you can, also we will produce the products according to your detail requests.

**\*Can you put my company's brand on your products?**

\*Yes, we accept OEM&ODM service. But we need some information about your company.

**\*How to install the roofing sheet?**

\*Please contact our service staff, we have installation video for you.

**\*Can you provide samples for me to open the market and test quality?**

\*Yes, we can. We can provide free samples to you, Could you pay the shipping cost? Please contact our service staff.

**\*What is your trade term?**

\* Payment: T/T 30% in advance, balance before shipment.

- Production Lead Time: Within 7 working days after 30% deposit
- FOB Shipping Port: Foshan, Guangzhou, Shenzhen