

Product show

ZXC China [Synthetic Resin Roofing Sheet](#) Sobrang tigas, 30 taong warranty. Gumagamit ito ng mas mahusay na resin bilang hilaw na materyal upang matiyak ang mas mahusay na tibay at mas mahabang buhay ng serbisyo. Ang ibabaw ay kasing liwanag ng salamin. Hindi naglalaman ng mga asbestos at radioactive na elemento, nare-recycle at ganap na nakakatugon sa mga kinakailangan sa pangangalaga ng kapaligirang berde. Mga high-grade na halaman, pabrika ng bakal, bodega, merkado ng sakahan, access sa merkado, shed at iba pang high-end na materyales sa bubong.

Resin tile dormer modeling design



pangalan ng Produkto	Synthetic Resin Roof Tile
Tatak	ZXC
Lugar ng Pinagmulan	Lungsod ng Foshan, lalawigan ng Guangdong, China(Mainland)
materyal	Acrylonitrile Styrene acrylate copolymer, Polyvinyl chloride, Calcium powder, iba pang kemikal na materyales
Garantiya	25 taon
Sertipikasyon	ISO9001 / SGS / CE
Oras ng paghatid	1x20GP para sa 6 na araw, 1x40GP para sa 7 araw
Haba ng Seksyon	219mm
Pangkalahatang lapad	1050mm
Epektibong Lapad	960mm
kapal	2.3mm / 2.5mm / 2.8mm / 3.0mm
Ang haba	Dapat ay maramihang seksyon
Wave Spacing	160mm
Taas ng alon	30mm

I-click [Ibinebenta ang ASA roofing sheets](#) para matuto pa

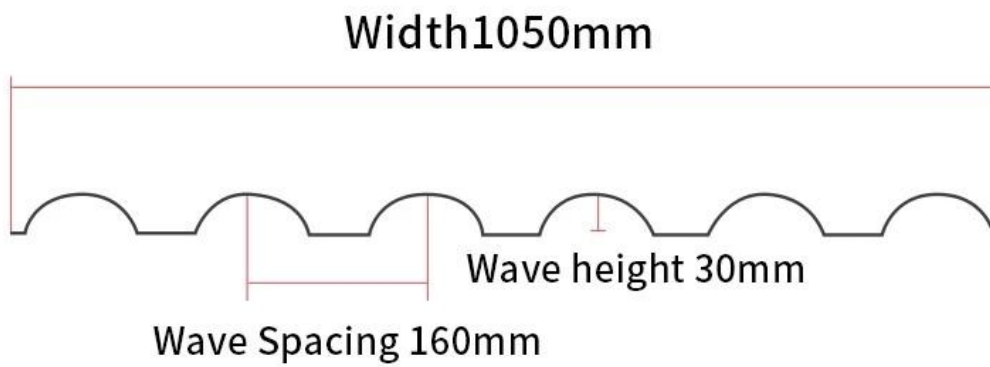

Brick red



Purplished red



Dark green

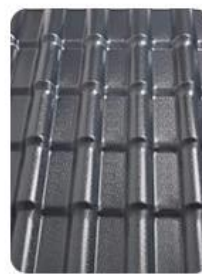

Gray



Blue

Application

- 1: It has long-lasting color
- 2: light weight,
- 3: self-waterproof,
- 4: tough, thermal insulation,
- 5: sound insulation
- 6: corrosion resistance
- 7: wind and shock resistance
- 8: hail resistance, and stain resistance
- 9: .Green environmental protection
- 10: fire prevention, insulation
- 11: easy installation

Dimensional measurement method

both sides

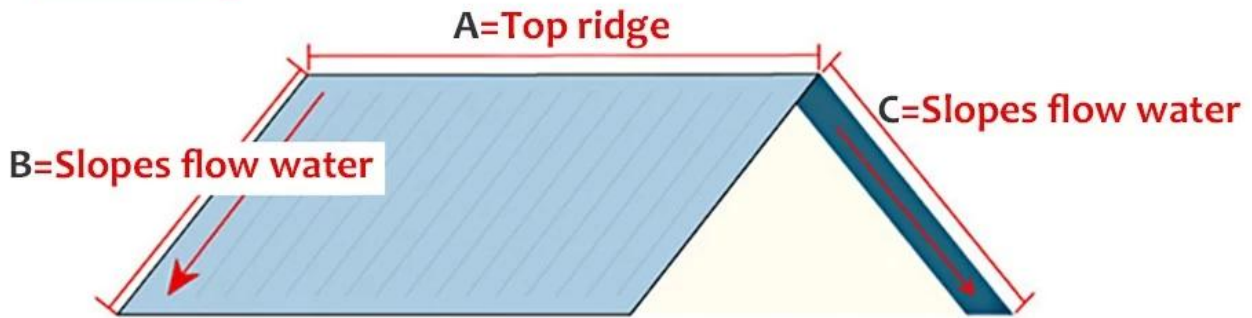

1. Measure the dimension of the **A** top ridge.
2. Measure the dimensions of **B**
3. Measure the dimensions of **C**

Measure all the dimensions (don't forget the eaves)

four sides

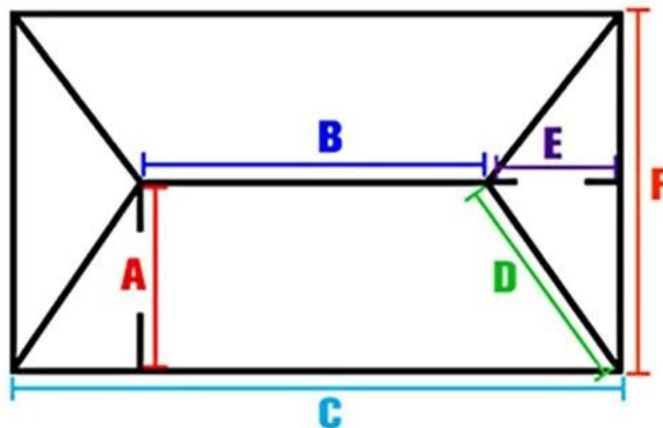

1. Measure the dimension of the **B** top ridge.
2. Measure the dimensions of ramp **A**
3. Measure the width of **C**
4. Measure the dimensions of the **D** diagonal ridge.
5. Measure the dimensions of ramp **E**
6. Measure the width of **F**

Measure all the dimensions (don't forget the eaves)

Project show pictures

Guangxi bungalow renovation



Qingyuan Scenic Area



Foshan residential roof



Renovation of old houses in Guangzhou



Our Factory

Matatagpuan ang Zhongxingcheng New Material Co., Ltd. sa Foshan City, Nanhai District China ay isang tagagawa na dalubhasa sa paggawa ng ASA synthetic resin tile, APVC anti-corrosion composite tile, PVC anti-corrosion tile, PVC sink, PVC plate, Transparent FRP Roof Sheet, PVC, PC transparent tile.



Factory display



9 production lines



Raw material warehouse



Product comparison

We're not afraid of contrast. Quality is the last word.

Zhongxingsheng



General manufacturers



Long-lasting color, durable



Inferior resin tiles are easy to fade



Only three layers of brand new material are produced.

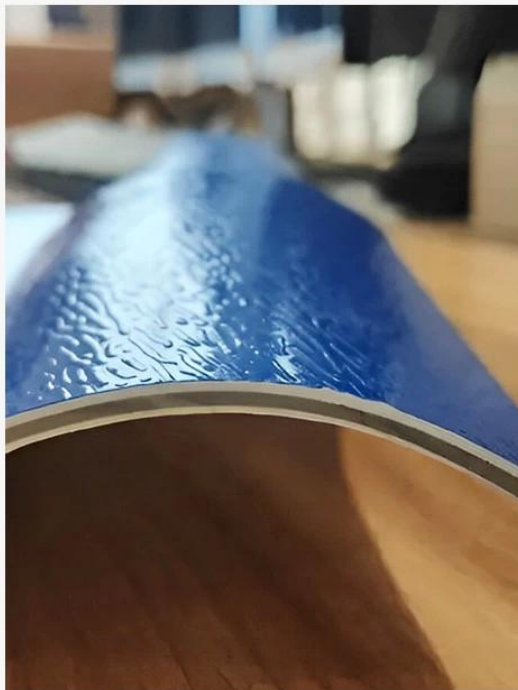

Four layers are compressed and mostly recycled material

Exhibition



Certificate

Official quality inspection, quality assurance

In line with the national roofing building materials standard.

序号	检测项目	单位	检测结果	标准要求	判定
1	外观	—	符合GB 12953-2008第4.1条要求	—	合格
2	拉伸强度	MPa	390.13	≥275	合格
3	伸长率	%	20.15	≥18	合格
4	撕裂强度	N	336	≥300	合格
5	冲击强度	MPa	2.96	≥2.00	合格
6	不透水性	—	不透	不透	合格
7	尺寸稳定性	mm	0.10	≤0.50	合格
8	低温弯折性	℃	-25	≤-15	合格
9	老化后性能	—	符合GB 12953-2008第4.3条要求	—	合格
10	尺寸稳定性 (老化后)	mm	0.10	≤0.50	合格
11	拉伸强度 (老化后)	MPa	372.00	≥275	合格
12	伸长率 (老化后)	%	19.10	≥18	合格
13	撕裂强度 (老化后)	N	312	≥300	合格
14	冲击强度 (老化后)	MPa	2.96	≥2.00	合格
15	不透水性 (老化后)	—	不透	不透	合格

检验报告
Test Report

佛山市质量计量监督检测中心
Foshan Supervision Testing Center of Quality and Metrology

佛山市质量计量监督检测中心
检验报告

No. Q1730194

产品名称: ASA合成膜瓦
规格: 2.3m
生产日期: 2014年12月10日
委托单位: 佛山市南海区丹灶镇新美“新造园”园林景观工程有限公司
检测机构: 佛山市质量计量监督检测中心

佛山市质量计量监督检测中心
检验报告

No. Q1730194

产品名称: ASA合成膜瓦
规格: 2.3m
生产日期: 2014年12月10日
委托单位: 佛山市南海区丹灶镇新美“新造园”园林景观工程有限公司
检测机构: 佛山市质量计量监督检测中心

佛山市质量计量监督检测中心
检验报告

No. Q1730194

序号	检测项目	单位	检测结果	标准要求	判定
1	外观	—	符合GB 12953-2008第4.1条要求	—	合格
2	拉伸强度	MPa	390.13	≥275	合格
3	伸长率	%	20.15	≥18	合格
4	撕裂强度	N	336	≥300	合格
5	冲击强度	MPa	2.96	≥2.00	合格
6	不透水性	—	不透	不透	合格
7	尺寸稳定性	mm	0.10	≤0.50	合格
8	低温弯折性	℃	-25	≤-15	合格
9	老化后性能	—	符合GB 12953-2008第4.3条要求	—	合格
10	尺寸稳定性 (老化后)	mm	0.10	≤0.50	合格
11	拉伸强度 (老化后)	MPa	372.00	≥275	合格
12	伸长率 (老化后)	%	19.10	≥18	合格
13	撕裂强度 (老化后)	N	312	≥300	合格
14	冲击强度 (老化后)	MPa	2.96	≥2.00	合格
15	不透水性 (老化后)	—	不透	不透	合格

Packaging



FAQ

***Tagagawa ka ba o mangangalakal?**

*Oo, kami ay tunay na Manufacturer, maraming mga larawan sa pagpapakilala ng aming kumpanya. Kung kailangan mo ng iba pang espesyal na produkto, gagawin namin ang aming makakaya upang matulungan ka, upang makagawa kami ng pangmatagalang relasyon sa negosyo.

***Maaari ba akong mag-order ng produkto gamit ang gusto kong i-profile?**

*Siyempre kaya mo, gayundin gagawa kami ng mga produkto ayon sa iyong mga kahilingan sa detalye.

***Maaari mo bang ilagay ang tatak ng aking kumpanya sa iyong mga produkto?**

*Oo, tumatanggap kami ng serbisyo ng OEM at ODM. Ngunit kailangan namin ng ilang impormasyon tungkol sa iyong kumpanya.

***Paano i-install ang roofing sheet?**

*Mangyaring makipag-ugnayan sa aming service staff, mayroon kaming installation video para sa iyo.

***Maaari ka bang magbigay ng mga sample para mabuksan ko ang merkado at masuri ang kalidad?**

*Oo, kaya namin. Maaari kaming magbigay ng mga libreng sample sa iyo, Maaari mo bang bayaran ang gastos sa pagpapadala? Mangyaring makipag-ugnayan sa aming kawani ng serbisyo.

***Ano ang iyong termino sa kalakalan?**

* Pagbabayad: T/T 30% in advance, balanse bago ipadala.

- Production Lead Time: Sa loob ng 7 araw ng trabaho pagkatapos ng 30% na deposito
- FOB Shipping Port: Foshan, Guangzhou, Shenzhen