

## Product show

ZXC China [Synthetic Resin Roofing Sheet](#) Super toughness, 30-year warranty. It uses better resin as raw material to ensure better toughness and longer service life. The surface is as bright as a mirror. Containing no asbestos and radioactive elements, recyclable and fully meeting green environmental protection requirements. High-grade plants, steel factories, warehouses, farm market, market access, sheds and other high-end roofing materials.

# Resin tile dormer modeling design



<b>Product Name</b>	Synthetic Resin Roof Tile
<b>Brand</b>	ZXC
<b>Place of Origin</b>	Foshan city, Guangdong province, China(Mainland)
<b>Material</b>	Acrylonitrile Styrene acrylate copolymer, Polyvinyl chloride, Calcium powder, other chemical materials
<b>Guarantee</b>	25 years
<b>Certification</b>	ISO9001 / SGS / CE
<b>Delivery Time</b>	1x20GP for 6 days, 1x40GP for 7 days
<b>Section Length</b>	219mm
<b>Overall Width</b>	1050mm
<b>Effective Width</b>	960mm
<b>Thickness</b>	2.3mm / 2.5mm / 2.8mm / 3.0mm
<b>Length</b>	Must be a multiple of section
<b>Wave Spacing</b>	160mm

Wave Height	30mm
-------------	------

Click [ASA roofing sheets on sale](#) to learn more

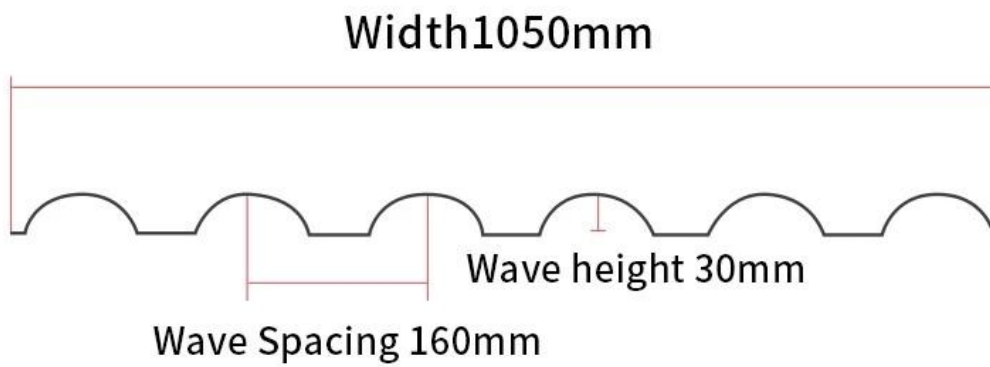

Brick red Purplished red Dark green Gray Blue

## **Application**

- 1: It has long-lasting color
- 2: light weight,
- 3: self-waterproof,
- 4: tough, thermal insulation,
- 5: sound insulation
- 6: corrosion resistance
- 7: wind and shock resistance
- 8: hail resistance, and stain resistance
- 9: .Green environmental protection
- 10: fire prevention, insulation
- 11: easy installation

# Dimensional measurement method

## both sides

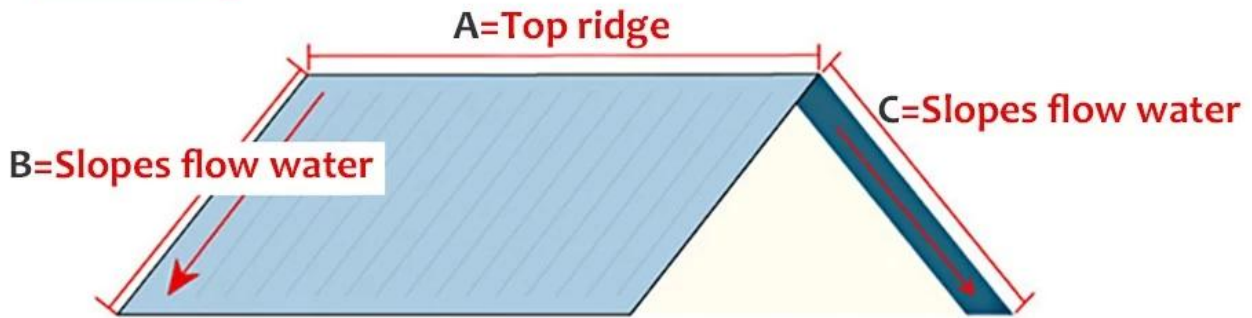

1. Measure the dimension of the A top ridge.
2. Measure the dimensions of B
3. Measure the dimensions of C

Measure all the dimensions (don't forget the eaves)

## four sides

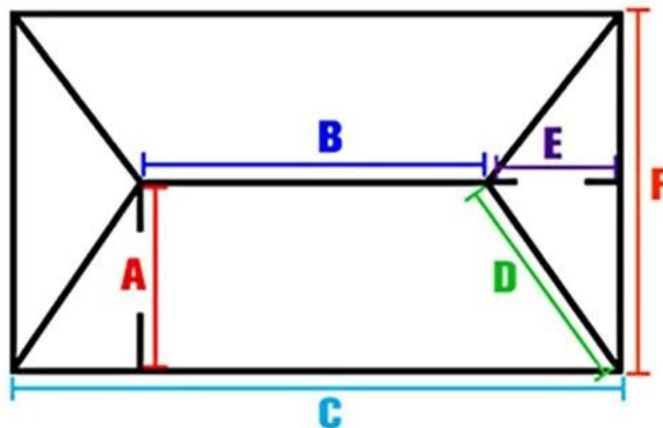

1. Measure the dimension of the B top ridge.
2. Measure the dimensions of ramp A
3. Measure the width of C
4. Measure the dimensions of the D diagonal ridge.
5. Measure the dimensions of ramp E
6. Measure the width of F

Measure all the dimensions (don't forget the eaves)

# Project show pictures

Guangxi bungalow renovation



Qingyuan Scenic Area



Foshan residential roof



Renovation of old houses in Guangzhou



# Our Factory

Zhongxingcheng New Material Co., Ltd. is located in Foshan City, Nanhai District China is a manufacturer specializing in the production of ASA synthetic resin tile, APVC anti-corrosion composite tile, PVC anti-corrosion tile, PVC sink, PVC plate, Transparent FRP Roof Sheet, PVC, PC transparent tile.





Factory display



9 production lines



Raw material warehouse



## Product comparison

We're not afraid of contrast. Quality is the last word.

Zhongxingsheng



General manufacturers



Long-lasting color, durable



Inferior resin tiles are easy to fade



Only three layers of brand new material are produced.

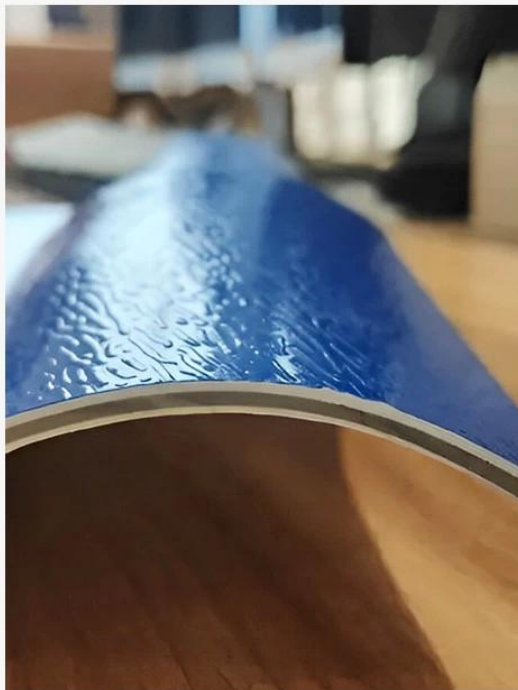

Four layers are compressed and mostly recycled material

# Exhibition



# Certificate



## Packaging



## FAQ

**\*Are you manufacturer or trader?**

\*Yes, we are real Manufacturer, there are many pictures in our company introduction .if you need other special product, we will do our best to help you, so we can build a long-term business relationship.

**\*Can I order the product with i want to profile?**

\*Of course you can, also we will produce the products according to your detail requests.

**\*Can you put my company's brand on your products?**

\*Yes,we are accept OEM&ODM service.But we need some information about your company.

**\*How to install the roofing sheet?**

\*Please contact our service staff, we have installation video for you.

**\*Can you provide samples for me to open the market and test quality?**

\*Yes,we can.We can provide free samples to you ,Could you pay the shipping cost?Please contact our service staff.

**\*What is your trade term?**

\* Payment: T/T 30% in advance, balance before shipment.

- Production Lead Time: Within 7 working days after 30% deposit
- FOB Shipping Port: Foshan,Guangzhou,Shenzhen