

Product show

ZXC ASA China plastic synthetic resin tile factory

Super toughness, 30-year warranty. It uses better resin as raw material to ensure better toughness and longer service life. The surface is as bright as a mirror. Containing no asbestos and radioactive elements, recyclable and fully meeting green environmental protection requirements. High-grade plants, steel factories, warehouses, farm market, market access, sheds and other high-end roofing materials.

ASA SYNTHETIC RESIN ROOFING TILES

Scenic areas and the pastoral farmhouse
use the most roofing tiles.

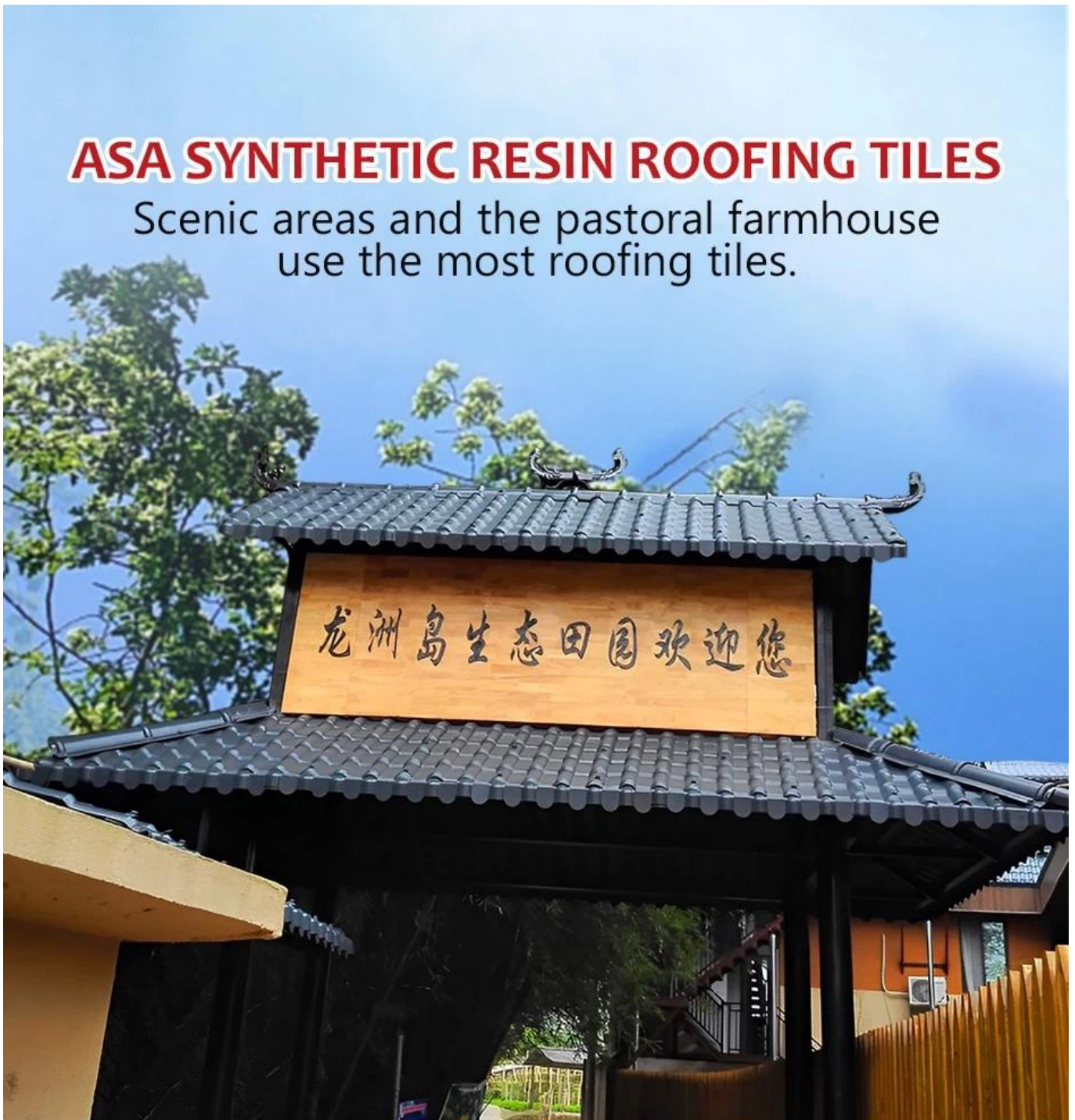



Product Name	Synthetic Resin Roof Tile
Brand	ZXC
Place of Origin	Foshan city, Guangdong province, China(Mainland)
Material	Acrylonitrile Styrene acrylate copolymer, Polyvinyl chloride, Calcium powder, other chemical materials
Guarantee	25 years
Certification	ISO9001 / SGS / CE
Delivery Time	1x20GP for 6 days, 1x40GP for 7 days
Section Length	219mm
Overall Width	1050mm
Effective Width	960mm
Thickness	2.3mm / 2.5mm / 2.8mm / 3.0mm
Length	Must be a multiple of section
Wave Spacing	160mm
Wave Height	30mm

Click [ASA synthetic resin tile factory](#) to learn more

Dimensional measurement method

both sides

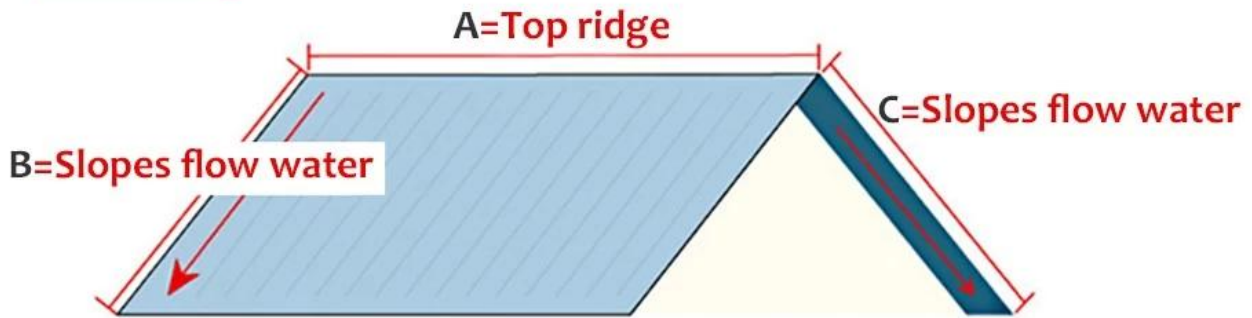

1. Measure the dimension of the **A** top ridge.
2. Measure the dimensions of **B**
3. Measure the dimensions of **C**

Measure all the dimensions (don't forget the eaves)

four sides

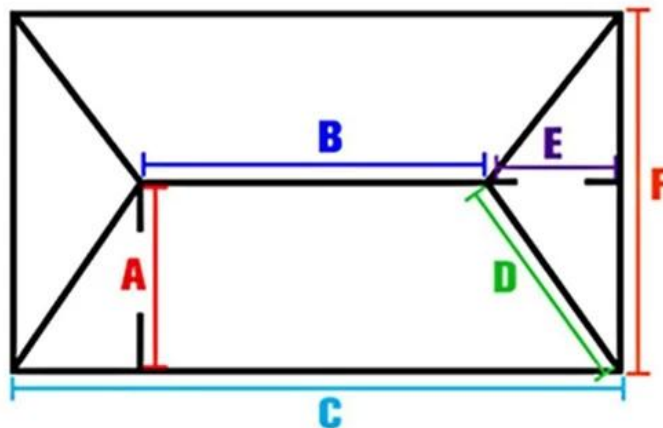

1. Measure the dimension of the **B** top ridge.
2. Measure the dimensions of ramp **A**
3. Measure the width of **C**
4. Measure the dimensions of the **D** diagonal ridge.
5. Measure the dimensions of ramp **E**
6. Measure the width of **F**

Measure all the dimensions (don't forget the eaves)

Roofing accessories

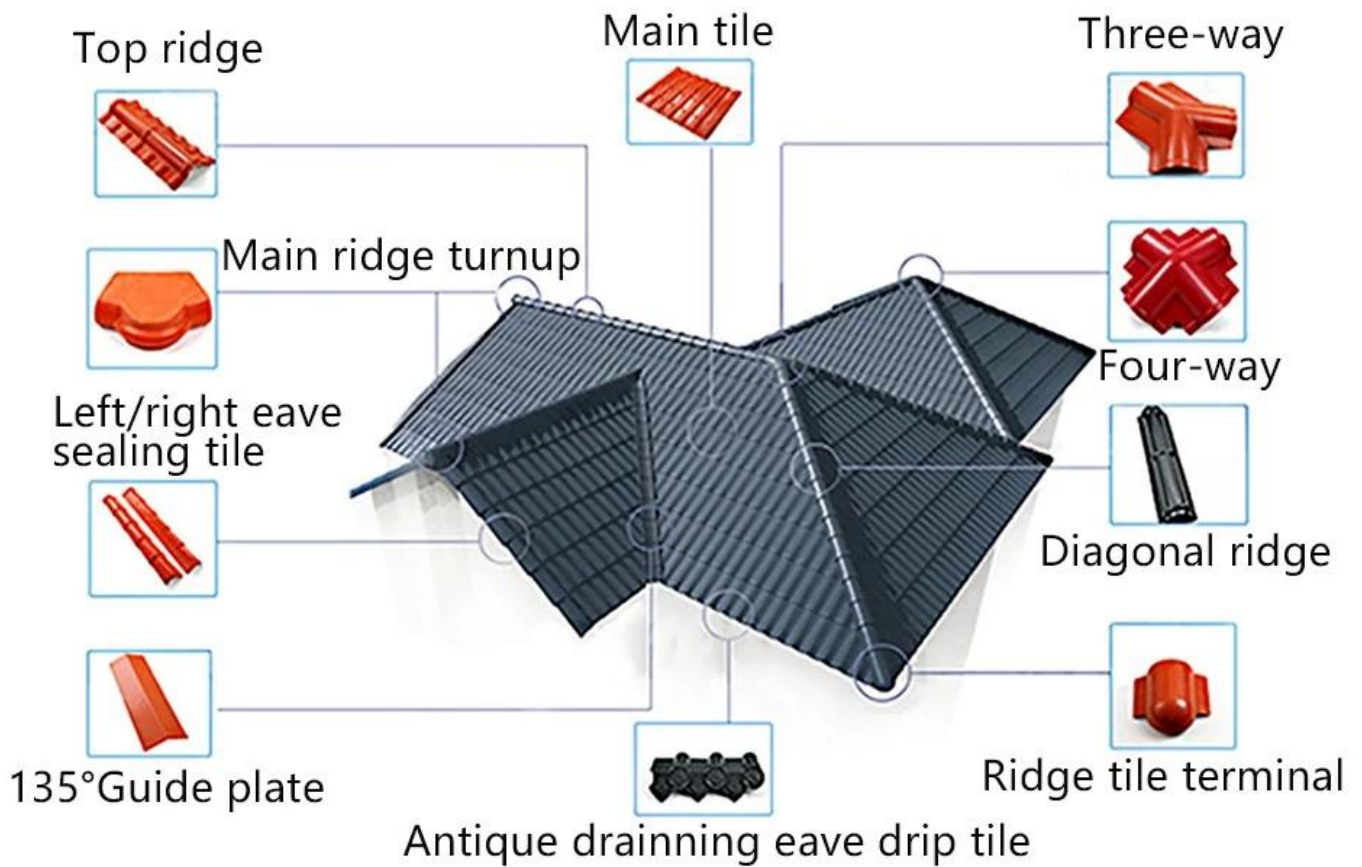

Installation considerations

1. The purlins can use square pipe (60x40x3mm)
2. The purlins can use C-shaped steel (100x50x20x3mm)
3. The purlins can use anti-corrosion wood square (60x40mm)
4. purlin spacing of 660mm

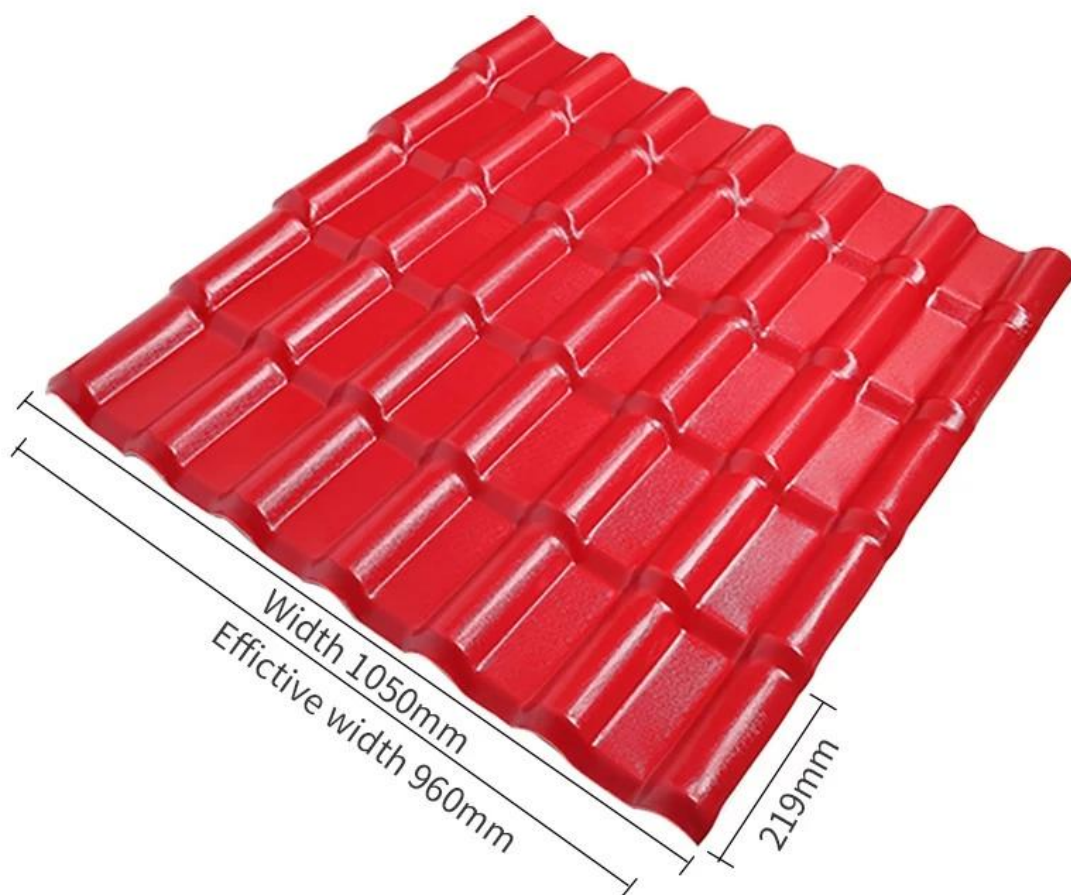

Name: synthetic resin

Model:1050mm

Material: synthetic resin

Origin: Foshan, Guangdong

Thickness: 2.5-3.0mm

Applicable scenarios: villa roofs, tourist attractions, rural transformation

Synthetic resin roofing tile color card selection

customized any color



Brick red



Purplished red



Dark green



Gray



Blue

Our Factory

Zhongxingcheng New Material Co., Ltd. is located in Foshan City, Nanhai District China is a manufacturer specializing in the production of ASA synthetic resin tile, APVC anti-corrosion composite tile, PVC anti-corrosion tile, PVC sink, PVC plate, Transparent FRP Roof Sheet, PVC, PC transparent tile.



Factory display



9 production lines



Raw material warehouse



Product comparison

Learn all about our products

Dacheng resin roofing tile

Recyclable resin roofing tiles



Brand new raw materials imported
bright color, long service life
30~50 years



Recycled materials, dull color, easy
to have black spots in appearance
very short life.



Brand new material, good
plasticization, long service life



Recyclable material, reduced
toughness, many impurities,
easy to break



ASA surface thickness 0.1~0.15mm
does not foam and does not fall off



The thickness of the surface layer of
the film is 0.05~0.1mm, which is
easy to blister and fall off

Exhibition



Certificate

Security sense of authoritative testing

Multiple quality inspection and testing to ensure good quality.



IOS9000 certified



China Metrology Certification



CAL certification



Packaging



FAQ

***Are you manufacturer or trader?**

*Yes, we are real Manufacturer, there are many pictures in our company introduction .if you need other special product, we will do our best to help you, so we can build a long-term business relationship.

***Can I order the product with i want to profile?**

*Of course you can, also we ([China synthetic resin roof tile factory](#)) will produce the products according to your detail requests.

***Can you put my company's brand on your products?**

*Yes, we accept OEM&ODM service. But we need some information about your company.

***How to install the roofing sheet?**

*Please contact our service staff, we have installation video for you.

***Can you provide samples for me to open the market and test quality?**

*Yes, we can. We can provide free samples to you, could you pay the shipping cost? Please contact our service staff.

***What is your trade term?**

* Payment: T/T 30% in advance, balance before shipment.

- Production Lead Time: Within 7 working days after 30% deposit
- FOB Shipping Port: Foshan, Guangzhou, Shenzhen