

Product show

ASA China 30

ASA SYNTHETIC RESIN ROOFING TILES

Scenic areas and the pastoral farmhouse use the most roofing tiles.

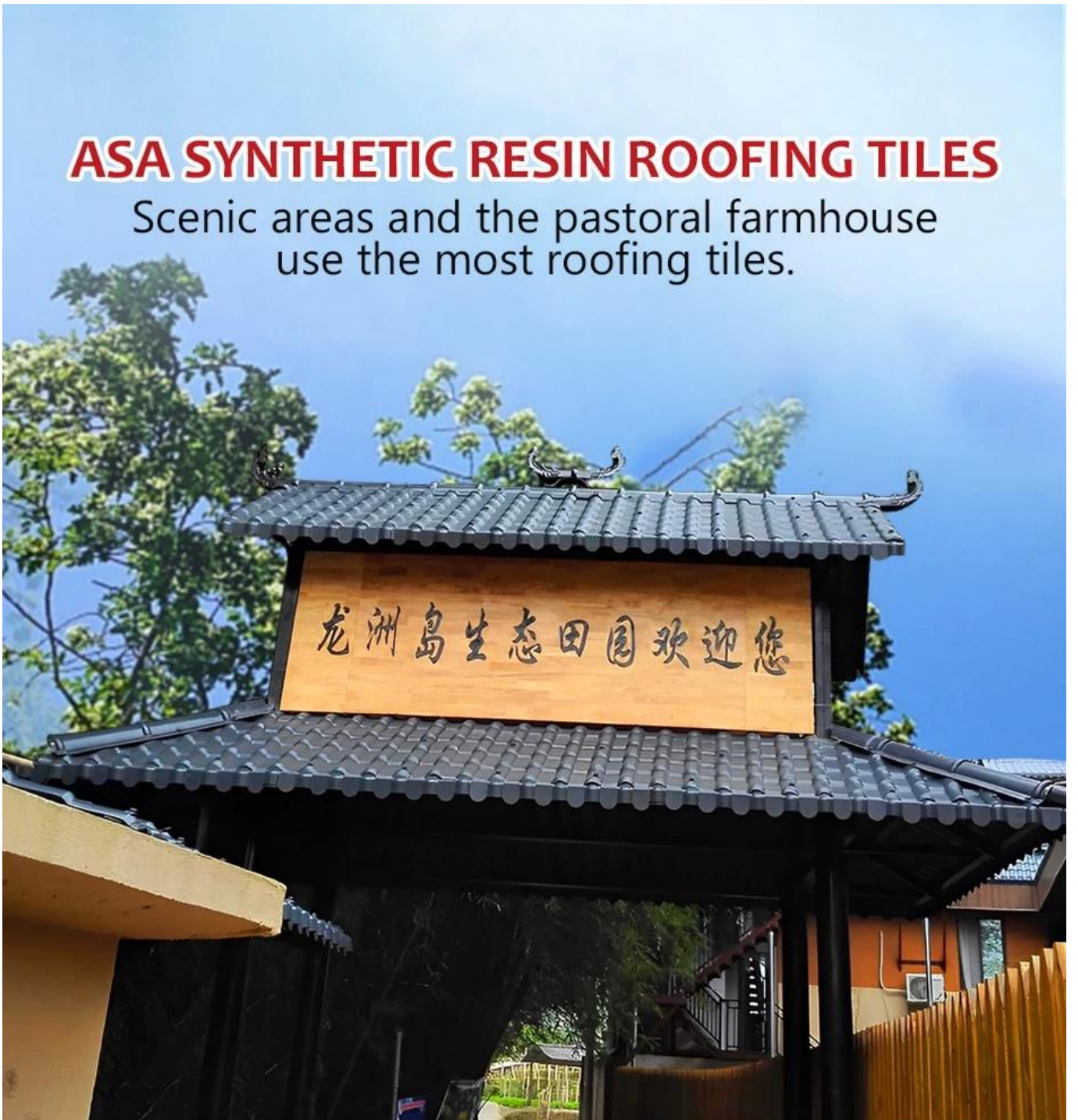



ISO 9001	ISO 9001
ISO 9001	ZXC
ISO 9001	ISO 9001 (ISO 9001)
ISO 9001	ISO 9001, ISO 9001, ISO 9001, ISO 9001
ISO 9001	25
ISO 9001	ISO9001/ISO9001/CE
ISO 9001	1x20GP 6, 1x40GP 7
ISO 9001	219
ISO 9001	1050
ISO 9001	960
ISO 9001	2.3, 2.5, 2.8, 3.0
ISO 9001	ISO 9001
ISO 9001	160
ISO 9001	30

ASA

Dimensional measurement method

both sides

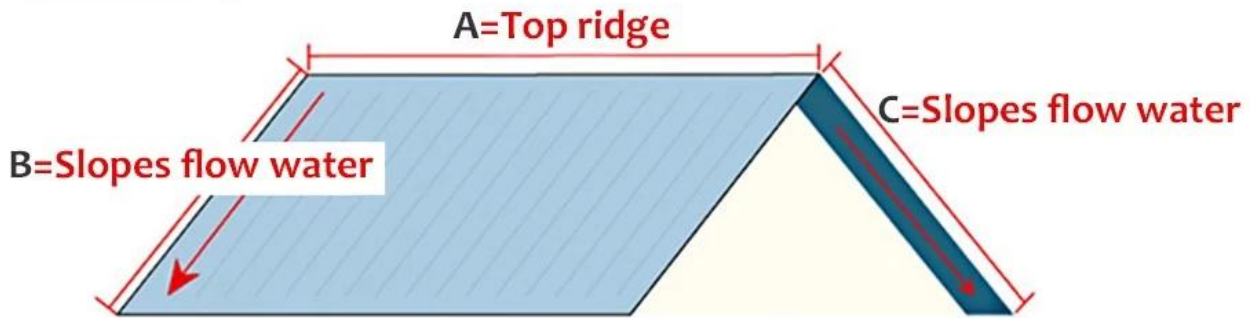

1. Measure the dimension of the **A** top ridge.
2. Measure the dimensions of **B**
3. Measure the dimensions of **C**

Measure all the dimensions (don't forget the eaves)

four sides

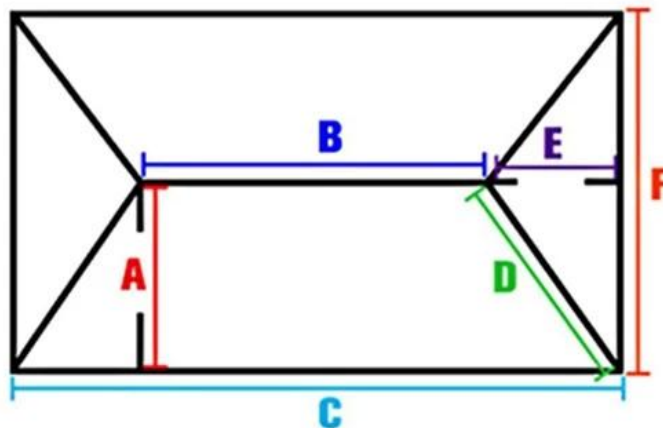

1. Measure the dimension of the **B** top ridge.
2. Measure the dimensions of ramp **A**
3. Measure the width of **C**
4. Measure the dimensions of the **D** diagonal ridge.
5. Measure the dimensions of ramp **E**
6. Measure the width of **F**

Measure all the dimensions (don't forget the eaves)

Roofing accessories

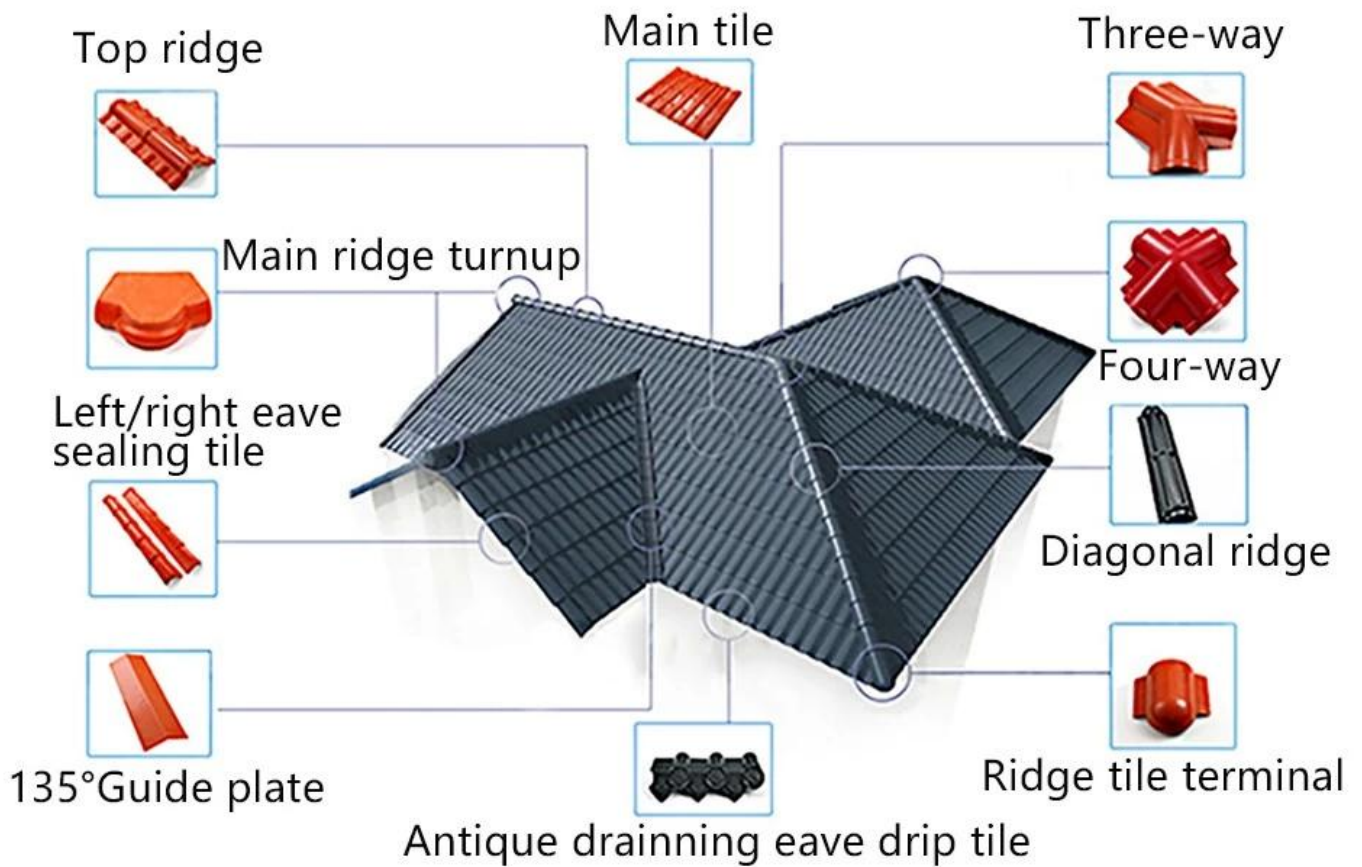

Installation considerations

1. The purlins can use square pipe (60x40x3mm)
2. The purlins can use C-shaped steel (100x50x20x3mm)
3. The purlins can use anti-corrosion wood square (60x40mm)
4. purlin spacing of 660mm

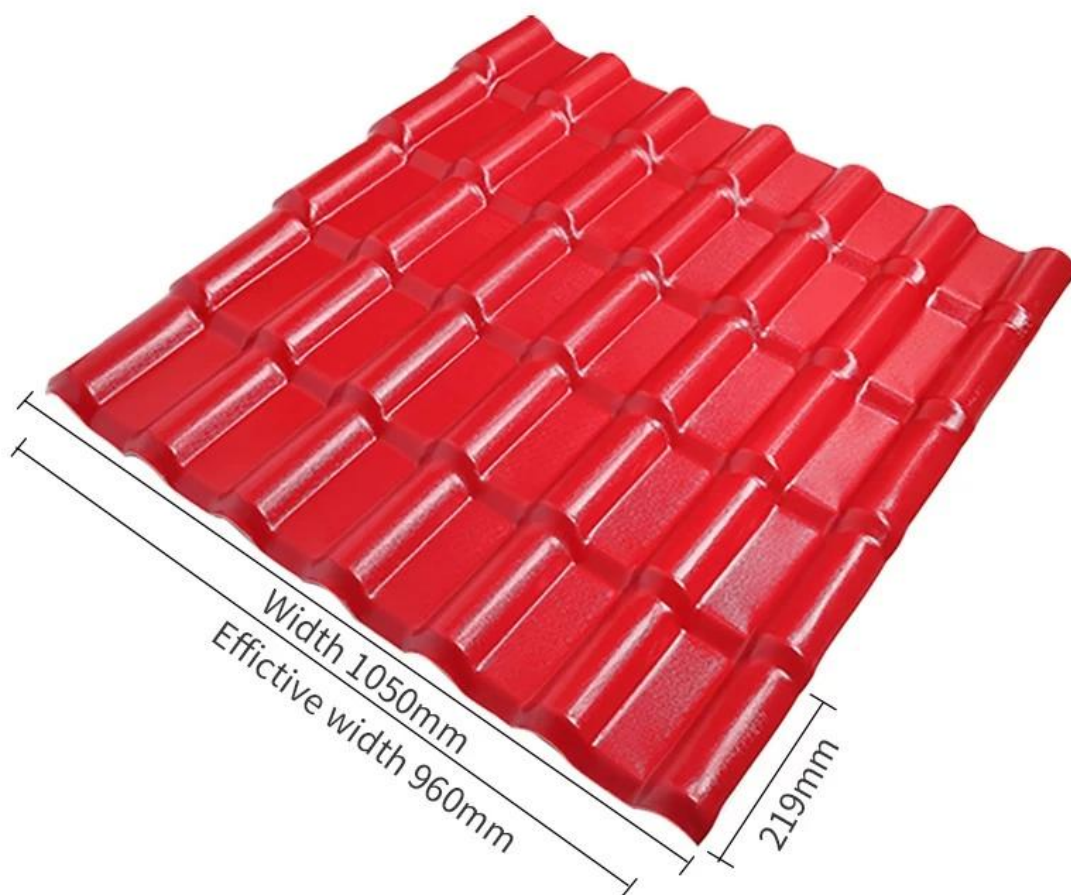

Name: synthetic resin

Model:1050mm

Material: synthetic resin

Origin: Foshan, Guangdong

Thickness: 2.5-3.0mm

Applicable scenarios: villa roofs, tourist attractions, rural transformation

Synthetic resin roofing tile color card selection

customized any color



Brick red



Purplished red



Dark green



Gray



Blue

Our Factory

Zhongxingcheng New Material Co., Ltd. 佛山市众兴晟新材料科技有限公司 Foshan City, Nanhai District China
ASA, APVC, PVC, FRP, PVC, PC



Factory display



9 production lines



Raw material warehouse



Product comparison

Learn all about our products

Dacheng resin roofing tile

Recyclable resin roofing tiles



Brand new raw materials imported
bright color, long service life
30~50 years



Recycled materials, dull color, easy
to have black spots in appearance
very short life.



Brand new material, good
plasticization, long service life



Recyclable material, reduced
toughness, many impurities,
easy to break



ASA surface thickness 0.1~0.15mm
does not foam and does not fall off



The thickness of the surface layer of
the film is 0.05~0.1mm, which is
easy to blister and fall off

Exhibition



Certificate

Security sense of authoritative testing

Multiple quality inspection and testing to ensure good quality.



IOS9000 certified



China Metrology Certification



CAL certification



Packaging



FAQ

* 如何包裝？

* 如何包裝？
如何包裝？
如何包裝？

* 如何包裝？

* 如何包裝？ (如何包裝？)

* 請提供貴公司之詳細資料及產品目錄？

* 請提供貴公司之詳細資料及產品目錄，OEM 或 ODM 均可。

* 請提供貴公司之詳細資料及產品目錄？

* 請提供貴公司之詳細資料及產品目錄，OEM 或 ODM 均可。

* 請提供貴公司之詳細資料及產品目錄？

* 請提供貴公司之詳細資料及產品目錄，OEM 或 ODM 均可。

* 請提供貴公司之詳細資料及產品目錄？

* 請提供貴公司之詳細資料及產品目錄，OEM 或 ODM 均可。

• 請提供貴公司之詳細資料及產品目錄，OEM 或 ODM 均可。

• FOB Shipping Port: 請提供貴公司之詳細資料及產品目錄。